

# The Blue Line

The Foust Marketing, Inc. Newsletter

## Inside this issue:

IPS Weld-On® Blue Seal Thread Sealant	1
Champion Strut™—Non-Metallic Fiberglass Strut System	1
IPS Adhesives—New Updated Website for Sign & Display	1
Pulsafeeder—Agricultural Applications	2
The Blue Line—Win Titleist Pro V1x Golf Balls	2

## IPS Weld-On® Blue Seal Thread Sealant



IPS Weld-On® is your source for Thread Sealants, Compounds, and Lubricants. Many installations and final connections require thread sealants. IPS Weld-On® Blue Seal Pipe Thread Sealant is an industrial grade, grit-free formula with

zero VOC content for industrial applications and pipe lines in high vibration environments.

Blue Seal can be used for sealing and lubricating metal and plastic piping systems carrying air & gases (compressed, manufactured or natural), ammonia, brine, acid (diluted), caustic alkalis (diluted), corrosives, freons, fuel (diesel, gasoline, jet fuel, and kerosene), oils, petroleum, propane, solvents, steam, sugar, and water. Not recommended for oxygen, fluorine or liquid sodium systems.

Blue Seal contains finely homogenized Teflon® PTFE particles to fully pack voids and thread imperfection ensuring pressure-tight, leak-proof seal on pipe threads.

Blue Seal has also been tested and chemically shown to be compatible and approved for use with FlowGuard Gold®, Blazemaster®, and Corzan® CPVC plastic piping systems.

For more information on their line of quality thread sealants, compounds, and lubricants, visit [IPS Weld-On Blue Seal](#).

## Industry Events

- AALSO (Aquatic Animal Life Support Operators)  
Pittsburg, PA  
March 27-31, 2021  
[www.aalso.org](http://www.aalso.org)
- WQA Aquatech (Water Quality Association)  
Orlando, FL  
April 1-3, 2021  
[www.wqa.org](http://www.wqa.org)

## Notes of Interest

- “Be devoted to one another in love. Honor one another above yourselves.”  
—Romans 12:10
- “I guess if a person never quit when the going got tough, they wouldn't have anything to regret for the rest of their life.”  
—Lance Armstrong (Dodgeball)

## Company News

- Foust Marketing has an OPEN position for Technical Sales  
[foustmarketing.com/careers](http://foustmarketing.com/careers).
- [PB-200](#) Cordless Power Beveller Stocking Program Available!

## Champion Strut™—Non-Metallic Fiberglass Strut System

Champion Strut™ is a fiberglass non-metallic channel framing system that includes a complete line of non-metallic accessories, fasteners, hangers, pipe clamps and channels that has been successfully used in many highly corrosive applications.

### Advantages

- Multiple strut channel profiles to accommodate any application.
- Non-metallic – materials available in polyester (dark grey) and

vinyl ester (beige) resin systems.

- A complete line of corrosion-resistant fiberglass components provides durability and contribute to project longevity.
- UV resistant – channels incorporate UV inhibitors and surfacing veil which improves weatherability and inhibits UV degradation.
- Fire retardant added protection.
- Lightweight for easy installation.
- Easy to field cut and drill

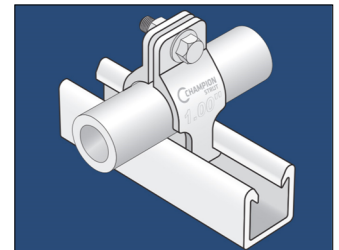

- CS-SST Series Channel (only) for stainless steel pipe straps.

Contact our sales team for more information or download the file at [Champion Strut Catalog](#).

## Pulsafeeder—Agricultural Applications



Pulsafeeder manufactures chemical metering pumps that precisely dose the required amount of chemical to prevent greening in citrus groves.

Greening is the effect experienced by the citrus tree when the root ball is malnourished and cannot grow to maturity. This malnutrition occurs because the soil is not acidic enough, thus the need to inject

sulfuric acid in drip irrigation lines. Irrigation is accomplished by installing a well head (strategically located) in the citrus grove, driven by diesel engines to service specific grove zones. The engine not only drives the well pump but charges a bank of 12V batteries to power the Pulsafeeder Series E-DC pumps. The Pulsafeeder Series E-DC pumps are used in the application where dosing is necessary in locations where there is no power source.

The chemical feed pumps inject acid and liquid fertilizer prior to the drip lines that feed the trees. Irrigation lines and injected chemicals condition the soil pH and allow for the root ball to blossom and the tree to mature and produce fruit.

## The Blue Line—Win Titleist Pro V1x Golf Balls

Foust Marketing is offering the opportunity to win a prize in this issue of [The Blue Line](#).

This issue we are offering a sleeve of **Titleist Pro V1x** logo golf balls from Foust Marketing to the top four entries.



Enter by visiting below link with the answers to the questions.

1. Why are Teflon® PTFE particles added to IPS Weld-On® Blue Seal thread sealant?
2. What non-metallic fiberglass materials is Champion Strut available?
- 3.
4. What Pulsafeeder chemical metering pump is used for acid

injection in the agricultural market?

5. What did Lance Armstrong say about quitting when the going got tough?

Winner of **Classic Thermapen** from the last issue courtesy of Meunier Technologies and Foust Marketing.

**Carolyn Sielfleisch**  
Cope Plastics—Hazelwood, MO

Complete the entry form at [www.foustmarketing.com/entry-form](http://www.foustmarketing.com/entry-form).



**foustmarketing, inc.**

*Engineered solutions for your business*

### Main Office

Foust Marketing, Inc.  
P.O. Box 7413  
The Woodlands, TX 77387-7413  
Tel: 281-296-2500  
Fax: 281-296-2566  
[www.foustmarketing.com](http://www.foustmarketing.com)

Pulsafeeder



NIBCO



King

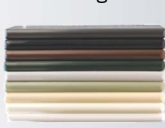

Harrison



IPS



IPS Adhesives



SWM



Lutz

