

Compact Economy Ball Valve - PVC

S45CE-E Socket/EPDM

T45CE-E Threaded/EPDM

S45CE-V Socket/Viton®

T45CE-V Threaded Viton®

APPLICATIONS

- For water distribution in industrial, residential, commercial and agricultural applications
- Multiple industrial uses

MATERIALS & CONSTRUCTION

- Sizes ½", ¾", 1", 1½", 1¾" and 2"
- Threaded NPT (female) or socket connections
- PTFE seat seals
- EPDM or Viton® (FKM) stem seals
- Gray PVC body, ball and stem
- Blue ABS Handle

DESIGN CRITERIA

- Durable one-piece molded body
- Convenient 1/4 turn operation
- Excellent flow characteristics
- Socket and threaded end connections per ASTM D2467 for Schedule 80 PVC pipe fittings
- Meets NSF Standard 14
- NPT threads per ANSI B1.20.1
- Rated for 150 PSI water service at 73°F and 50 PSI service at 140°F
- Low cost and economical



45CE

Viton® is a registered trademark of E.I. DuPont Co.

Compact Economy Ball Valve

www.nibco.com/chemtrol

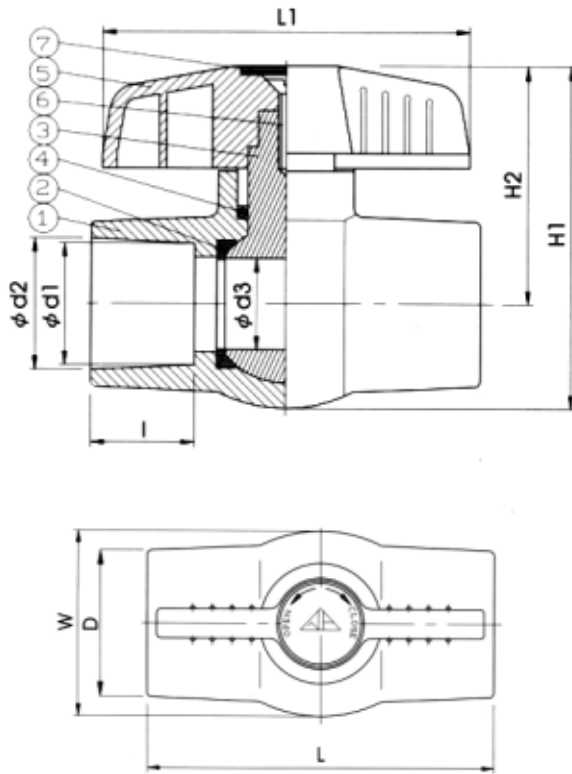

45CE

Material List	
PART	SPECIFICATION
1. Body	PVC
2. Seat Seal (2)	PTFE
3. Ball	PVC
4. O-Ring	EPDM, FKM
5. Handle	ABS
6. Bolt	Zinc-Plated Steel
7. Cap	ABS

C _v [GPM/1PSI]	
SIZE	C _v
1/2"	8.84
1"	25.24
1 1/4"	38.53
1 1/2"	51.28
2"	96.67

DIMENSIONS—WEIGHTS—QUANTITIES

Size	Dimensions													
	In.	mm	Thd./In. (NPT)	d1.	d2	d3	D	L	L1	l	H1	H2	W	Weight/lbs.
1/2	15	14		0.84	0.85	0.55	1.18	3.27	2.76	0.87	2.44	1.69	1.50	0.18
3/4	20	14		1.05	1.06	0.79	1.50	3.74	3.46	1.00	3.07	2.13	1.93	0.21
1	25	11.5		1.31	1.32	0.98	1.77	4.17	3.94	1.12	3.66	2.56	2.24	0.49
1 1/4	32	11.5		1.65	1.67	1.18	2.13	4.48	3.94	1.25	3.86	2.64	2.48	0.64
1 1/2	40	11.5		1.89	1.91	1.42	2.44	5.12	4.29	1.38	4.53	3.07	2.95	0.94
2	50	11.5		2.37	2.39	1.83	3.03	5.79	5.28	1.50	5.31	3.50	3.62	1.50

Chemtrol[®]
a brand of **NIBCO**

NIBCO INC.
WORLD HEADQUARTERS
WEB: www.nibco.com

1516 MIDDLEBURY STREET
ELKHART, IN 46516-4740
USA

CHEMTROL CUSTOMER SERVICE
PHONE: 800.343.5455
FAX: 800.541.3841

TECHNICAL SERVICE
PHONE: 888.446.4226
FAX: 888.336.4226

INTERNATIONAL OFFICE
PHONE: +1/574.295.3221
FAX: +1/574.295.3455